



A Ramsey Industries Brand

HERCULES 50000

Heavy Duty Planetary

50,000 lb Rated Line Pull

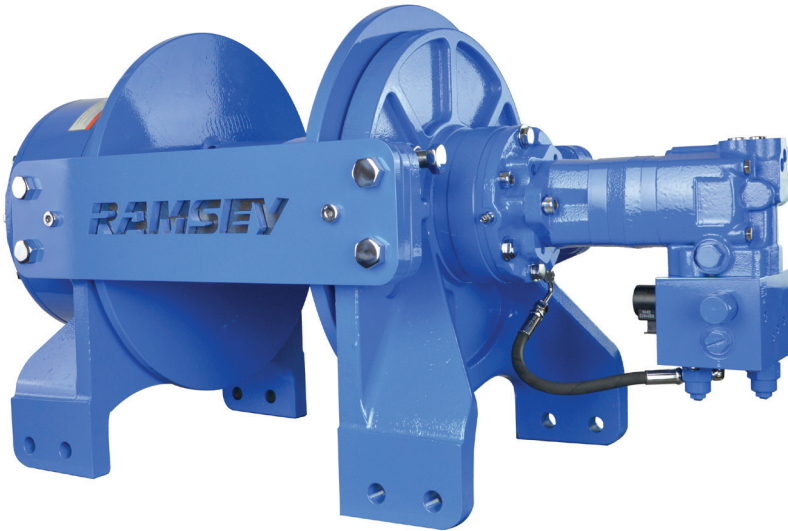

Dual drag brakes



Superior cable-management
Roller Tensioner

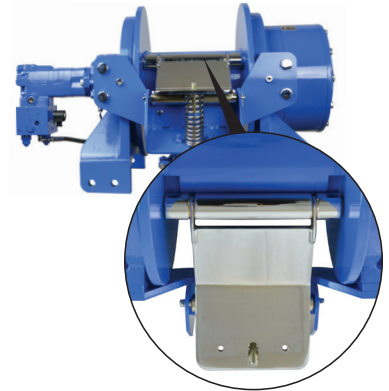

FEATURES AND BENEFITS

- Synthetic rope approved
 - 12 strand (HMPE), commonly known as Dyneema
 - Maximum Winch capacity is 250 ft.
- Less weight
 - 20% lighter than the competition
 - Stronger design
- Fast line speed
 - Up to 20 ft/min under full load
- Compact design
 - Optimizes space usage
 - Increased cable capacity
- Negative draft clutch design
 - Ensures positive hold on load
- Internal air-shift free spool
 - Enables remote operations
- Low temperature shifting (down to -40° F/C)
 - Allows for extreme cold weather operation
- High-efficiency gear set
 - Optimizes performance
- Superior cable management
 - Roller Tensioner
 - Improved bird nesting control
 - Constant spring force
 - Adjustable pneumatic force
 - Dual adjustable drag brakes
- Two speed motor
 - 12 or 24 VDC 2-speed shifting
 - Reliable control signal
- Fabricated drum
 - Straight flanges reduce cable climbing
 - Cable anchors (2)
 - Left and right side
- Bi-directional winch
 - Flexibility for over or under winding
 - Dual cartridges c/b valves for easy rotation change
- Optional high angle roller tensioner
 - Designed for high angle boom applications

HERCULES 50000 SPECIFICATIONS

Rated Line Pull (Low Speed)	50,000 lb (22,680 kg)
Weight (without Cable)	740 lb (336 kg)
Gear Reduction	51.35:1

HERCULES 50000 STANDARD DRUM

Layer of Cable		1	2	3	4	5	6
Rated Line Pull / Layer* (Low Speed)	lbs.	50,000	41,800	36,000	31,600	28,100	25,400
	kgs.	22,680	18,960	16,329	14,334	12,746	11,521
Rated Line Pull / Layer* (High Speed)	lbs.	25,000	20,900	18,000	15,800	14,050	12,700
	kgs.	11,340	9,480	8,165	7,167	6,373	5,761
Line Speed – Low (at 25 GPM)*	FPM (MPM)	20 6.1	22 6.7	25 7.6	28 8.5	31 9.4	35 10.7
	FPM (MPM)	40 12.2	44 13.4	50 15.2	56 17.1	62 18.9	70 21.3
Cable Capacity* Standard Drum	ft	25	60	100	145	190	250
	m	7.6	18.3	30.5	44.2	57.9	76.2

*Specifications based on recommended wire rope of .75 inch dia. EIPS cable and 11.9 cu. in./rev. motor at 2900 psi working pressure.
 * Use only Ramsey Winch recommended synthetic rope.
 – Directional control valve: 3-position, 4-way motor spool. – Winch meets SAE J706.

STRENGTH. DEPENDABILITY. DURABILITY.

4707 N. Mingo Road, Tulsa, OK 74117 | ramseywinch.com | Phone: 1-800-777-2760

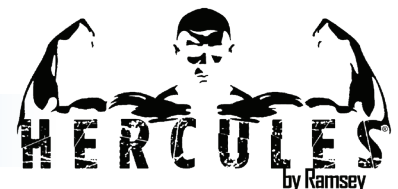

Hercules 50000 Heavy Duty Planetary

Rated Line Pull 50,000 lb

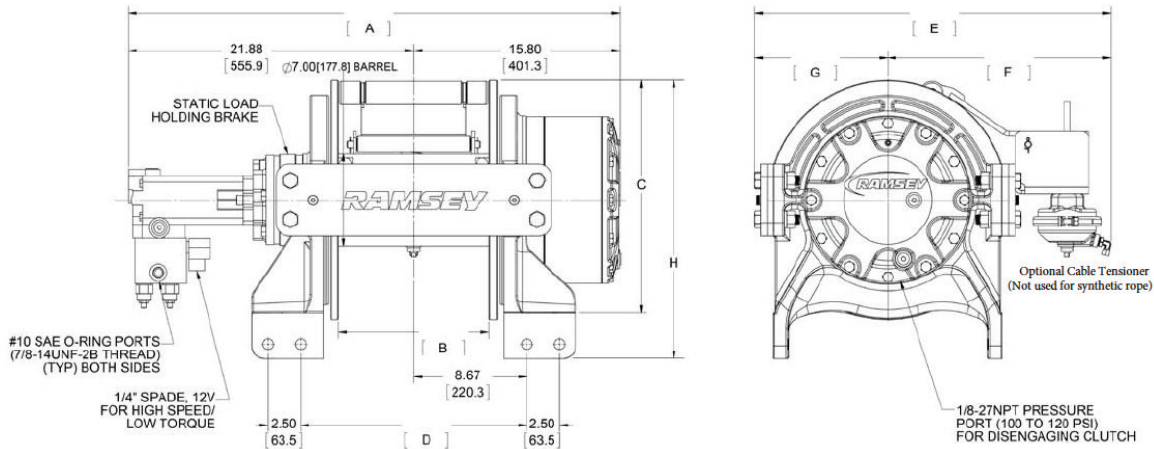

WINCH MODEL	A INCHES (mm)	B INCHES (mm)	C INCHES (mm)	D INCHES (mm)	E INCHES (mm)	F INCHES (mm)	G INCHES (mm)	H INCHES (mm)
Standard Drum	37.68 957.2	11.54 293.2	18.25 463.6	17.34 440.4	27.31 693.6	17.09 434.1	10.22 259.6	21.25 539.8

PERFORMANCE WITH 11.9/5.95 IN³ 2-SPEED HYDRAULIC MOTOR

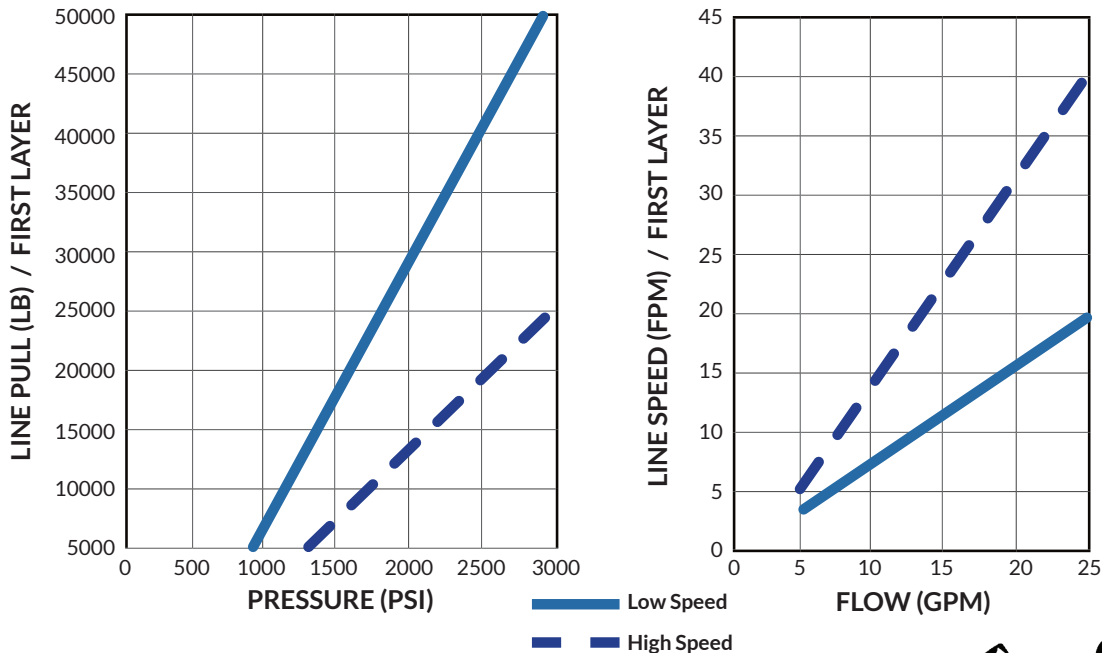

STRENGTH. DEPENDABILITY. DURABILITY.

4707 N. Mingo Road, Tulsa, OK 74117 | ramseywinch.com | Phone: 1-800-777-2760

